

Polls & Surveys Manual

Polls & Surveys Menu

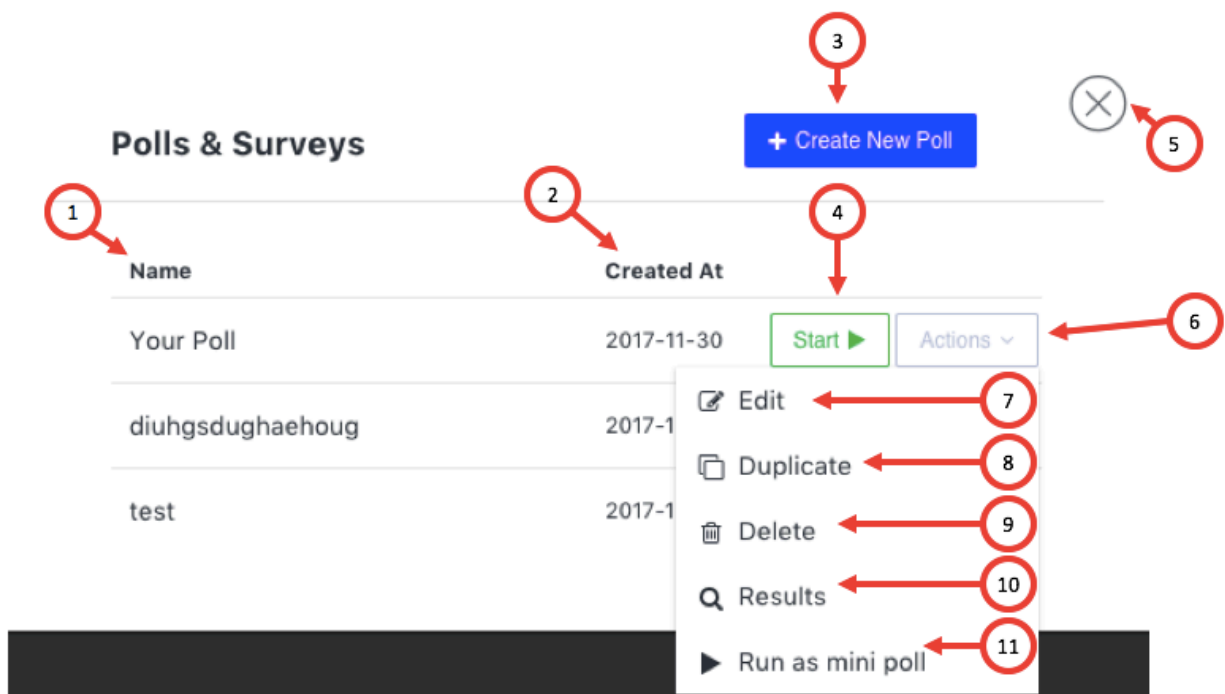

1. Name - here you will find a list of the polls which you created earlier
2. Created At - here you will find a date when you created certain poll/survey
3. Create New Poll – when clicking on this button you will start creating new poll (see [Create New Poll](#))
4. Start - when clicking this button, you will start the poll for the participants in your room
5. Close - clicking this button will close the Polls& Surveys menu
6. Actions - clicking this button will open a dropdown menu
7. Edit - you can edit poll/survey
8. Duplicate - you can duplicate poll/survey
9. Delete - you can delete the poll/survey you don't need anymore
10. Results - here you will find the votes of the participants
11. Run a mini poll – this will open a poll in the window below the chat (see [Mini Poll window](#))

Create New Poll

The image shows a 'New Poll' form with the following elements and callouts:

- 1**: Points to the 'Poll Name:' label.
- 2**: Points to the 'Add Questions >' link.
- 3**: Points to the 'Save Survey' button.
- 4**: Points to the 'Cancel' button.
- 5**: Points to the close button (X icon) in the top right corner.

The form includes a text input field for the poll name and three buttons: 'Add Questions >', 'Save Survey', and 'Cancel'.

1. Poll Name - here you add name of your poll/survey
2. Add Questions - here you are adding questions to poll/survey (see [Add Questions Menu](#))
3. Save Survey - this button directs you to add Questions Menu
4. Cancel - If you don't want to create poll click this button
5. Close - If you don't want to create poll click this button

Add Questions Menu

The screenshot shows the 'New Poll test 2' interface. At the top right, there are three circular icons labeled 8, 9, and 10, each with an arrow pointing to a file, audio, and emoji icon respectively in the question text field. A fourth circular icon labeled 11 has an arrow pointing to a close button (X) in the top right corner. Below the question field, there are two 'Answer Text' input fields, each with a trash icon to its right. A blue '+ Add Answer' button is located below the second answer field. At the bottom, there are three buttons: a blue 'Save Survey' button, a white 'Cancel' button, and a blue '< Poll details Remove question Another question >' button. Red circles with numbers 1 through 11 are placed around the interface, with arrows pointing to the corresponding elements.

1. Question - you add your question here
2. Answer type - you can choose from three kinds of answers. "Single" - means that the attendee can choose only one answer. "Multi" - means that attendee can choose few answers to one question. "Open" - means that the attendee needs to give his/her answer.
3. Answer Text - you add possible answers to your questions here
4. Add answer - if you need more than two answers please click this button to add another answer
5. Poll Details - give you the poll info. Remove question – delete the question you don't need. Another question - adds another question to your poll/survey
6. Save Survey
7. Cancel - if you don't want to create poll click on this button
8. Add file question - you can also add file answer
9. Audio file question - you can also add audio file answer

10. Emoticons – you can use emoticons in your questions and answers
11. Close

Mini Poll window

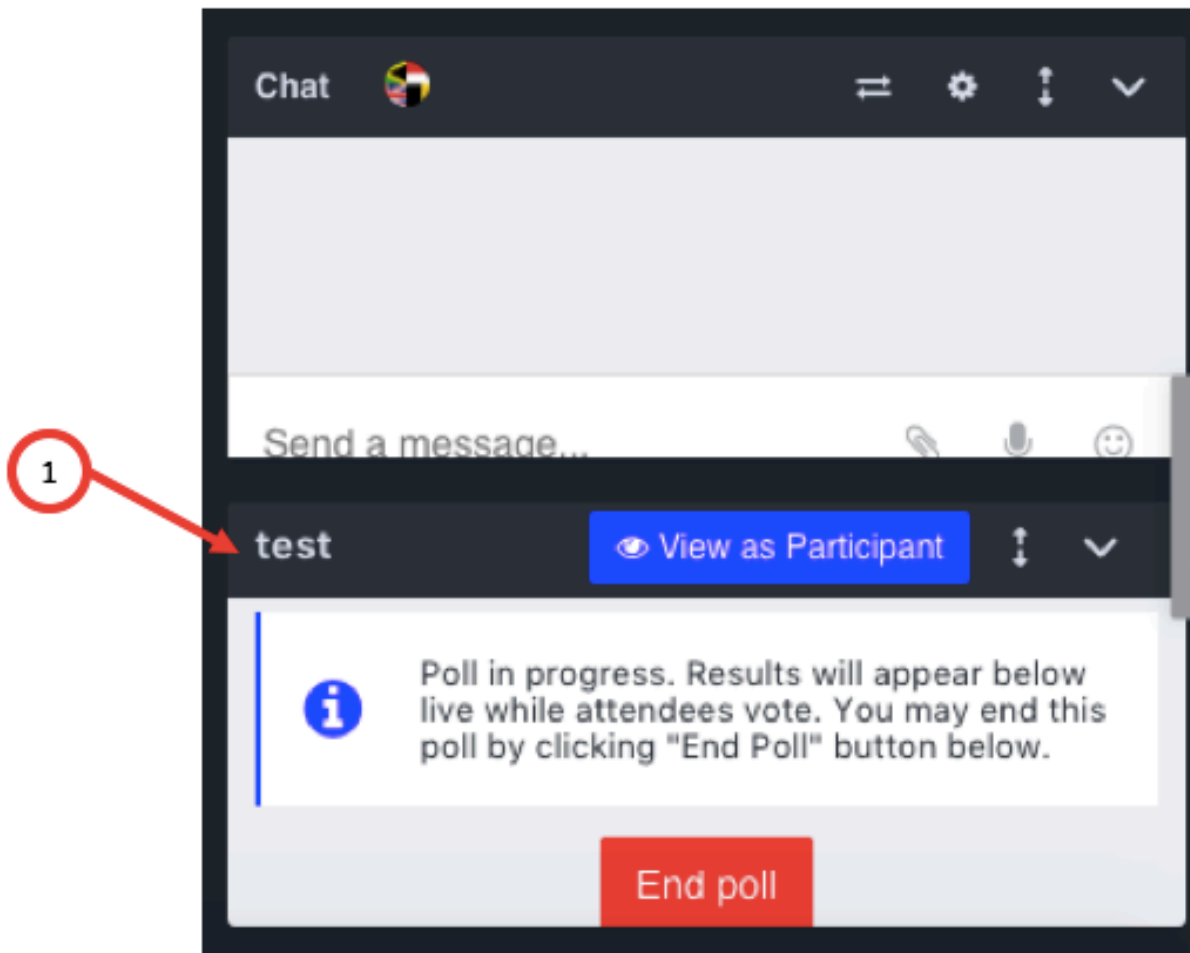

1. Mini Poll window under the Chat window

Poll window – participant view



1. Question
2. Answers
3. Finish poll - when you answered all the questions you click it
4. View as Manager - when you are a Host or Presenter who started the poll you can also view it as its manager